

# ELEVATORS

perma lubrication systems in operation



## Challenges

Cable guide pulleys and guide rails for passenger cabs and counterweights must be permanently lubricated to prevent friction and wear. Automatic lubrication with perma lubrication systems guarantees adequate lubrication and reduces maintenance and cleaning work in passenger cabs and shafts while minimising vibrations and noise and reducing unscheduled maintenance. Anyone looking for safe, effective and long-term economical lubrication of elevators takes advantage of perma lubrication systems.

- Contamination of guide rails
- Costly cleaning
- Oil spills on passenger cabs
- "Stick-slip effect"
- Strong vibrations and noise make passengers feel uneasy
- Costly repairs
- Risk of injury on sharp edges
- High occupational safety risk during maintenance work in the shaft



## Lubrication points

### ELEVATORS

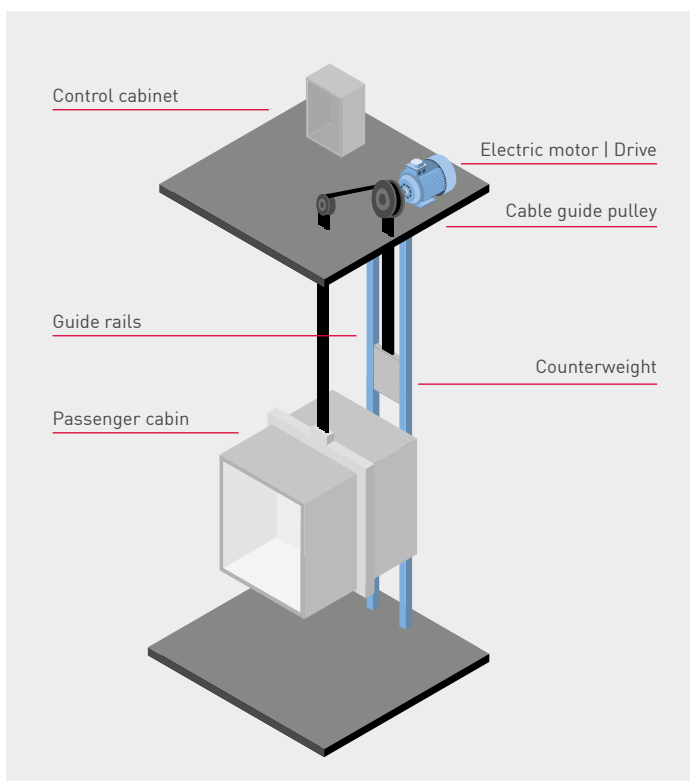

- **Cable guide pulley**  
Regular lubrication of the cable guide pulley of an elevator is important to reduce friction and wear, extend the service life, and ensure smooth operation.
- **Guide rails of the passenger cabin**  
Constant lubrication of the guide rails reduces friction, resulting in smooth and quiet operation of the elevator. Properly lubricated guide rails also help minimise wear and extend equipment service life.
- **Guide rails of the counterweight**  
The guide rails of the counterweight serve to guide and securely position the counterweight along the shaft. Recurring lubrication of counterweight guide rails reduces friction, resulting in smooth and efficient lubrication of the elevator.



Lubrication of guide rails on counterweights



Lubrication of guide rails on passenger cabs



Lubrication of cable guide pulleys

## Solutions

The selection of the ideal lubrication solution requires the consideration of various factors, including the specific type of application, operating speed and load of the machine, and the ambient temperature. Below is one proposed solution:

### Direct mounting | e.g. with perma FLEX

- Easy, quick mounting
- For lubrication points with little vibration | shocks
- For easy-to-reach and safe lubrication points

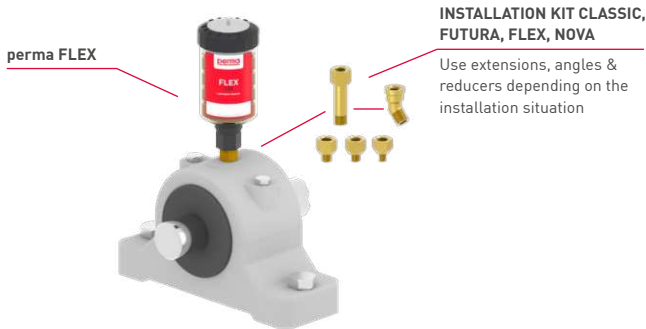

## perma SERVICES

You have questions about our products or need assistance with the survey, system installation and maintenance of your equipment? The perma Services team has answers and is happy to assist!



Visit the perma website for an overview of our offerings.



# EASY. SMART. CONNECTED.

Create your own network

- Current overview of all lubrication points
- Coordination of upcoming maintenance work
- Reminders for pending exchanges
- Central management of lubrication points in the web application
- Recording of all on site maintenance and exchange tasks via the app

Get perma CONNECT now!

Download the app to your smartphone or open the web application at <https://perma-connect.com>

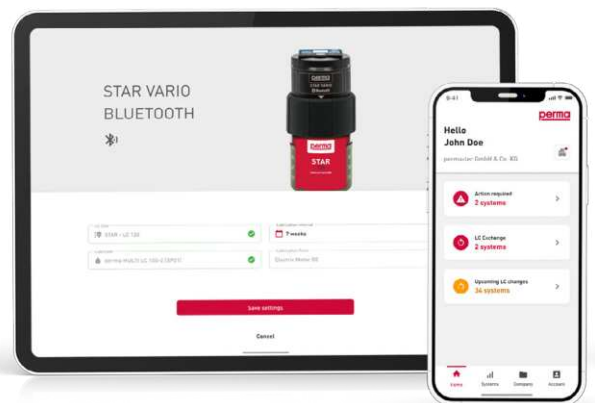

Find a variety of videos on the perma YouTube channel to get a deeper understanding of the perma CONNECT app.





**perma-tec GmbH & Co. KG**  
Hammelburger Str. 21  
97717 Euerdorf  
GERMANY

Tel.: +49 9704 609 - 0  
info@perma-tec.com  
www.perma-tec.com

