

perma STAR VARIO | STAR VARIO BLUETOOTH

Quick Start Guide



HINT
perma STAR VARIO
BLUETOOTH



perma CONNECT



1. Predefine installation / Select lubricant, discharge period + connecting parts

Examples: Bearing lubrication

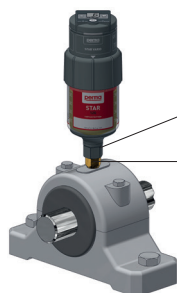

Direct mounting

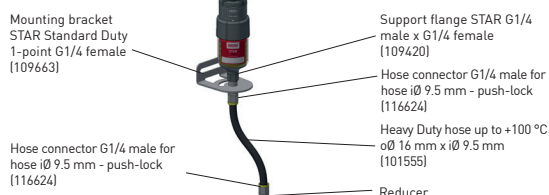

Remote mounting → for lube-points with vibration, limited mounting space, high temperature

Select a suitable lubricant for perma STAR LC unit

→ e. g. perma MULTI LC 150-2 (SF01)

Select discharge period

→ e. g. with perma SELECT APP
(refer to our product catalog for details)

Possible mounting positions:

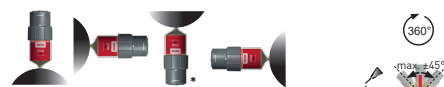

* This position is not possible when a protection cap is used

2. Prepare lube-point

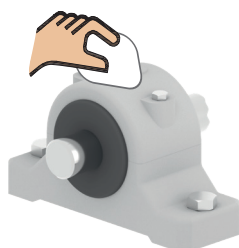

Clean lube-point

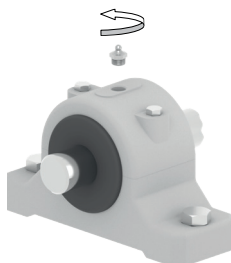

Remove grease fitting

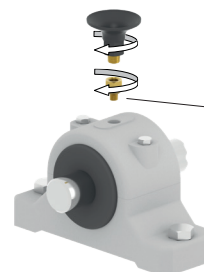

Add sealant (e. g. Loctite® 243™)

Add reducer, support flange and tubes (if required)



For direct mounting:
Prefill lube-point and any connecting parts
(use the same grease that is contained in the lubrication system)



For remote mounting:
Prefill lube-point and any grease lines / connections
(use the same grease that is contained in the lubrication system)

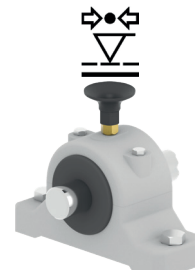

Pressure check: Lube-point / all connecting parts
(refer to perma STAR VARIO installation guide for details)

3. Activation / Installation of lubrication system

